

8	.4375-28	0.827	21.00	0.594	15.09	.120	3.05	.370	.940	.474	12.04	.322	8.18	.069	1.75	.308	7.83	.447	11.35
10	.5625-24	0.953	24.2	0.719	18.26	.120	3.05	.370	.940	.591	15.01	.322	8.18	.069	1.75	.308	7.83	.447	11.35
12	.6875-24	1.047	26.6	0.812	20.62	.120	3.05	.370	.940	.751	19.08	.322	8.18	.069	1.75	.308	7.83	.447	11.35
14	.8125-20	1.141	28.98	0.906	23.01	.120	3.05	.370	.940	.876	22.25	.322	8.18	.069	1.75	.308	7.83	.447	11.35
16	.9375-20	1.234	31.34	0.969	24.61	.120	3.05	.370	.940	1.001	25.43	.322	8.18	.069	1.75	.308	7.83	.447	11.35
18	1.0625-18	1.327	33.7	1.062	26.97	.120	3.05	.370	.940	1.126	28.60	.322	8.18	.069	1.75	.308	7.83	.447	11.35
20	1.1875-18	1.453	36.9	1.156	29.36	.120	3.05	.370	.940	1.251	31.78	.322	8.18	.069	1.75	.308	7.83	.447	11.35
22	1.3125-18	1.578	40.08	1.25	31.75	.120	3.05	.370	.940	1.376	34.95	.322	8.18	.069	1.75	.308	7.83	.447	11.35
24	1.4375-18	1.703	43.26	1.375	34.93	.147	3.73	.370	.940	1.501	38.31	.322	8.18	.069	1.75	.308	7.83	.447	11.35

[MIL-DTL-38999 Insert and Contact Identification](#)

[MIL-DTL-38999 Insert Arrangements](#)

[MIL-DTL-38999 Contacts, Tooling, Wire Sizes, Sealing Plugs](#)

[Series II Polarization & Shell Keying](#)

[Series II Panel Cut-Out Dimensions](#)

[Series I & II Strain Reliefs](#)

Shell	A	B	C	D	E	F	G	H	J
8	.620	.564	.120	1.215	.446	.052	.087	3/16-20 UNF	
10	.854	.719	.120	1.215	.446	.062	.087	3/16-20 UNF	
12	1.047	.906	.120	1.215	.446	.062	.087	7/8-20 UNF	
14	1.141	.906	.120	1.215	.446	.062	.087	1-20 UNF	
16	1.234	.969	.120	1.215	.446	.062	.087	1-20 UNF	
18	1.327	1.062	.120	1.215	.446	.062	.087	1-1/16-18 UNF	

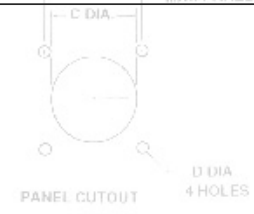

Shell	A	B
8	.620	.564
10	.854	.719
12	1.047	.906
14	1.141	.906
16	1.234	.969
18	1.327	1.062

MILITARY PART NUMBERING SYSTEM

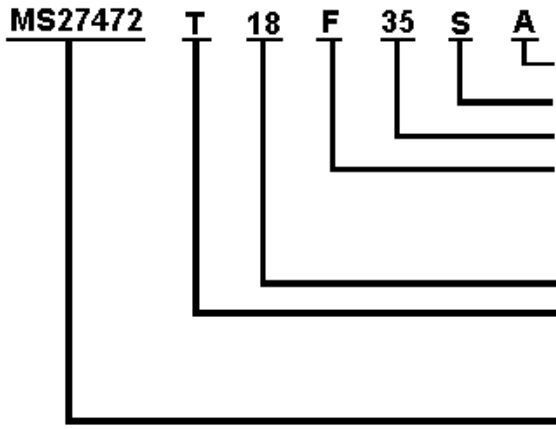

- Polarization (not required for normal)**
- Contact Style (P for Pin, S for Socket)**
- Insert Arrangement (Refer to MIL-C-38999 Insert Arrangements)**
- Finish:**
 - B= Aluminum, olive drab cadmium over nickel -65 C to +175C**
 - C= Aluminum, Anodic (Non-Conductive) -65 C to +200 C**
 - F= Aluminum, electroless nickel, -65 C to +200 C**
- Shell Size: (even numbers only, 8 thru 24)**
- Class:**
 - T= Environmental with accessory threads and teeth (with exception of box mount version)**
 - E= Environmental (box mount versions only)**
- MS Number**
 - MS27472= wall mount flange receptacle**
 - MS27473= standard plug**
 - MS27474= jam nut mount receptacle**
 - MS27499= box mount receptacle**
 - MS27508= box mount flange receptacle**
 - MS27497= back panel wall mount receptacle**
 - MS27484= RFI Plug**
 - MS27513= box mount flange long grommet receptacle**

For pricing and availability, please fill out our RFQ form



If you need any other information, please [E-Mail aecs@aecsinc.com](mailto:aecs@aecsinc.com)



phone (703) 425-3815 fax (703) 425-3814

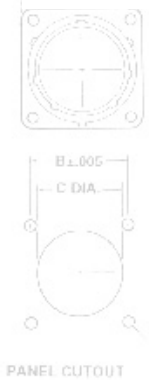

Shell	A	B
8	.620	.564
10	.854	.719
12	1.047	.906
14	1.141	.906
16	1.234	.969

We look forward to hearing from you!

20	1.418	1.250	1.485	1.20	1.275	1/2	094	212	1.7/16-18 UNF
22	1.578	1.250	1.485	1.20	1.275	1/2	094	212	1.7/16-18 UNF
24	1.708	1.375	1.615	1.47	1.275	1/4	094	212	1.7/16-18 UNF

20	1.418	1.100							
22	1.578	1.250							
24	1.708	1.375							

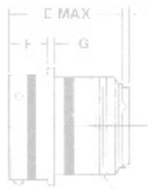

1.00
.190

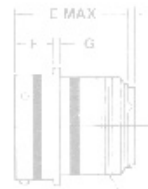
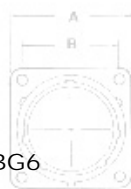

1.00
.190

A Woman Owned Small Business, CAGE Code 07BG6



H —
MAX PANEL

J THREAD

Copyright © 2008 Allen Electric Connector Sales, Inc. All Rights Reserved.



H —
MAX PANEL

J THREAD