

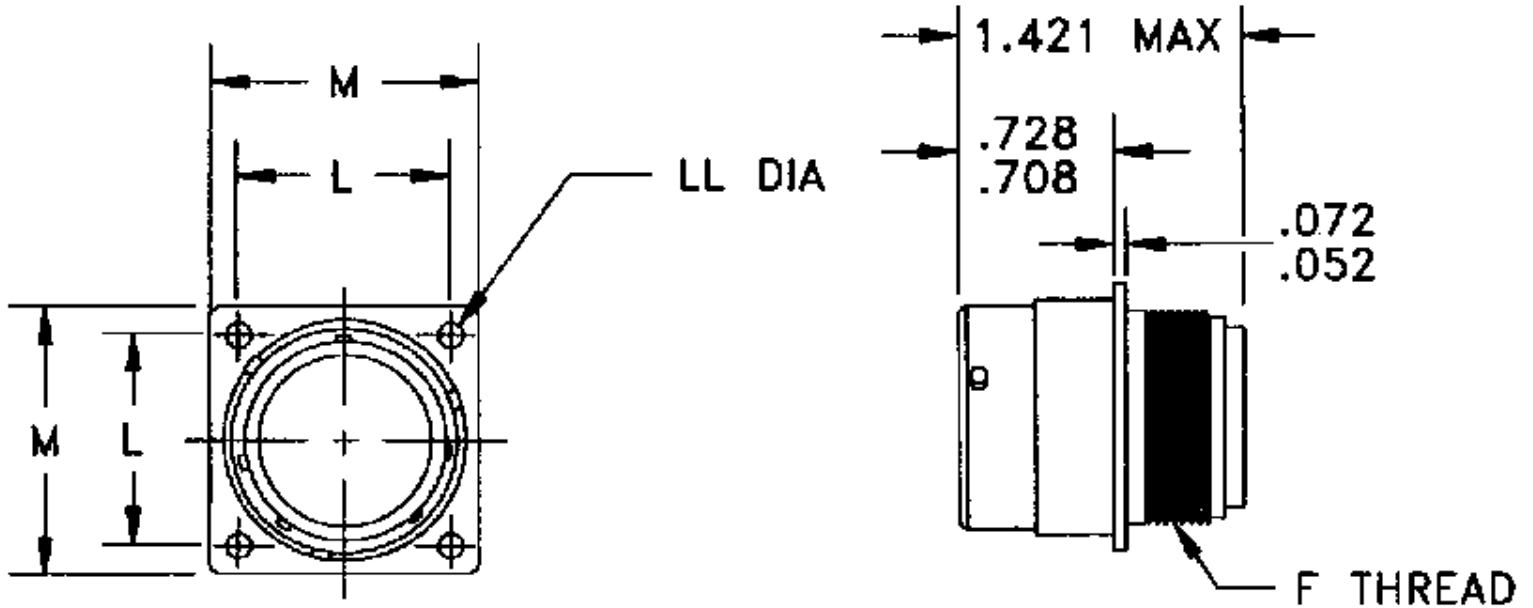

# Allen Electric Connector Sales, inc.



## MS24264 SQUARE FLANGE BAYONET RECEPTACLE



SHELL SIZE	L CL-CL MOUNTING HOLE	M $\pm .010$	LL DIA. $+.000$ $-.009$	MAX PANEL THICKNESS	F THREAD CLASS 2A
8	.594	.812	.125	.125	7/16-28 UNEF
10	.719	.937	.125	.125	9/16-24 UNEF
12	.812	1.031	.125	.125	3/4-20 UNEF
14	.906	1.125	.125	.125	13/16-20 UNEF
16	.969	1.250	.125	.125	15/16-20 UNEF
18	1.062	1.343	.125	.125	1 1/16-18 UNEF
20	1.156	1.437	.125	.125	1 3/16-18 UNEF
24	1.375	1.703	.154	.125	1 7/16-18 UNEF

[MIL-DTL-26500 Polarizing Locksmith Keyed Positions](#)  
[MIL-DTL-26500 Insert Arrangements](#)  
[Panel Cut-Out Dimensions](#)

# MILITARY PART NUMBERING SYSTEM

**MS24264**

**R**

**22**

**B**

**12**

**S**

**Y**

Polarization (N for normal, Alternates 6,7,8,9 or Y)

Contact Style (P for Pin, S for Socket)

Insert Arrangement (2 thru 61 per MIL-STD 1554)

Coupling (T= Threaded, B= Bayonet)

Shell Size: Even numbers 8 thru 24

Environmental Class: R= MIL-C-26500 (USAF)

MS Number

MS24264 (Square Flange Receptacle)

MS24265 (Jam Nut Receptacle)

MS24266 (Plug)

24	1.709	1.375	1.615	.97	1.275	1.04	.994	.212	1.7516-8 UNF
----	-------	-------	-------	-----	-------	------	------	------	--------------

For pricing and availability, please fill out our RFO form



If you need any other information, please E-Mail [aecs@aecsinc.com](mailto:aecs@aecsinc.com)



phone (703) 425-3815 fax (703) 425-3814

We look forward to hearing from you!



A Woman Owned Small Business, CAGE Code 07BG6