



# Allen Electric Connector Sales, inc.



TM

## MIL-DTL-26482 SERIES II POLARIZING POSITIONS

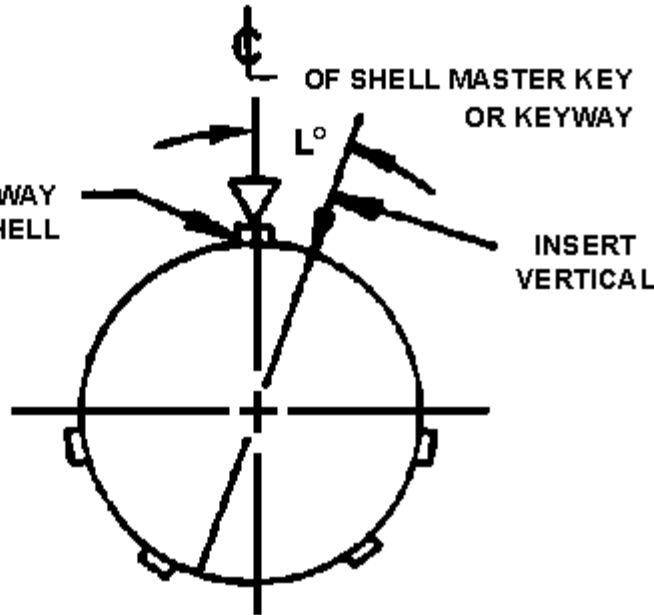

The normal position (N) has the insert centerline that coincides with the centerline of the master keyway of the shell. The alternate clocking positions (W,X,Y, and Z) are done by rotating the pin insert clockwise. The socket insert is rotated counter clockwise. The drawing above shows the insert rotation clockwise with the tables showing the degree of

SHELL SIZE	A	B	C	D	E	F	G	H	J
8-2	MAX	±0.05	±0.02	±0.03	MAX	-0.1	+0.10	MAX	1/4-20 UNF
8-3									5/8-24 UNF
8-4									3/4-20 UNF
8-33									7/8-20 UNF
8-98 <sup>AD</sup>									1-20 UNF
10-6									1 1/16-18 UNF
10-98									1 3/16-18 UNF
12-3									1 5/16-18 UNF
12-8									1 7/8-18 UNF
12-10									2-18 UNF
14-4									2 1/4-18 UNF
14-5									2 1/2-18 UNF

Shell Size	A	B	C	D	E	F	G	H	J
10	954	719	585	120	1215	440	052	087	5/8-24 UNF
12	1047	812	664	120	1215	440	052	087	3/4-20 UNF
14	1141	906	769	120	1215	440	052	087	7/8-20 UNF
16	1234	1000	1115	120	1215	440	052	087	1-20 UNF
18	1328	1092	1235	120	1215	440	052	087	1 1/16-18 UNF
20	1422	1180	1365	120	1215	440	052	087	1 3/16-18 UNF

SHELL SIZE & INSERT ARRANGEMENT	L DEGREES					Service Rating
	N	W	X	Y	Z	
8-2	0	58	122	-	0	I
8-3	0	60	210	-	-	I
8-4	0	45	-	-	-	I
8-33	0	90	-	-	-	I
8-98 <sup>AD</sup>	0	-	-	-	-	I
10-6	0	90	-	-	-	I
10-98	0	90	180	240	270	I
12-3	0	90	112	203	292	I
12-8	0	90	112	203	292	I
12-10	0	60	155	270	295	I
14-4	0	45	92	184	273	I
14-5	0	40	92	184	273	II

rotation.

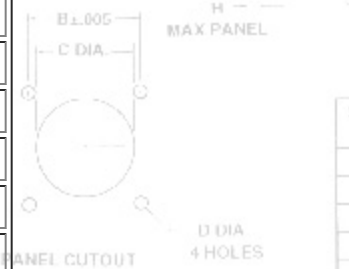
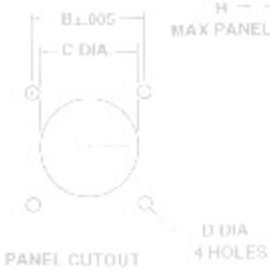
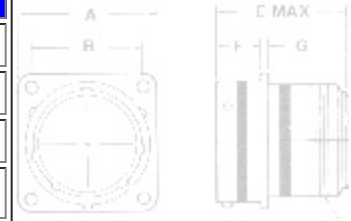
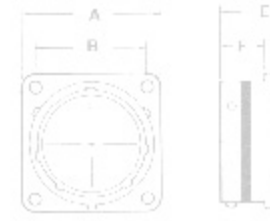
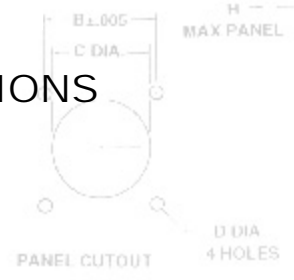

14-9	0	15	90	180	240	I				
14-12	0	43	90	-	-	I				
14-15	0	17	110	155	234	I				
14-18	0	15	90	180	270	I				
SHELL SIZE & INSERT ARRANGEMENT	L DEGREES					Service Rating				
	N	W	X	Y	Z					
14-19	0	30	165	315	-	I				
14-22	0	45	-	-	-	I				
16-8	0	54	152	180	331	II				
16-14	0	25	78	180	240	I				
16-23	0	158	270	-	-	I				
16-26	0	60	125	275	338	I				
16-95	0	25	90	153	-	I				
16-99	0	66	156	223	340	I				
18-8	0	180	-	-	-	I				
18-11	0	62	119	241	340	II				
18-30	0	180	193	285	350	I				
18-32	0	85	138	222	265	I				
18-85	0	45	90	180	240	I				
18-88	0	12	45	168	202	I				
20-16	0	238	318	333	347	II				
20-24	0	70	145	215	290	I				
SHELL SIZE & INSERT ARRANGEMENT	L DEGREES					Service Rating				
	N	W	X	Y	Z					
20-27	0	72	144	216	288	I				
20-39	0	63	144	252	333	I				
20-41	0	45	126	225	-	I				
20-90	0	18	60	240	270	I				
22-12	0	-	-	-	-	I				
22-19	0	15	90	225	308	I				
22-21	0	16	135	175	349	II				
22-32	0	72	145	215	288	I				
22-34	0	62	142	218	298	I				
22-41	0	39	135	264	-	I				
22-55	0	30	142	226	314	I				
22-95	0	26	180	266	-	I				
22-96	0	19	41	-	-	I				
24-19	0	30	165	315	-	II				
24-27	0	45	110	140	225	I				
22	1	50	485	1275	72	094	312	1511	18	LINE

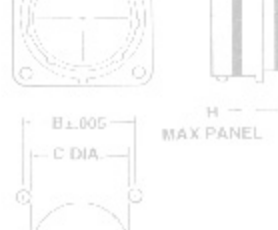
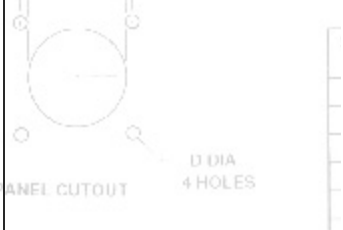
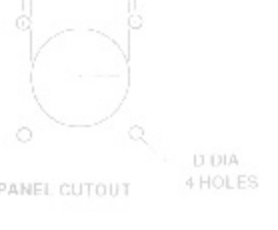
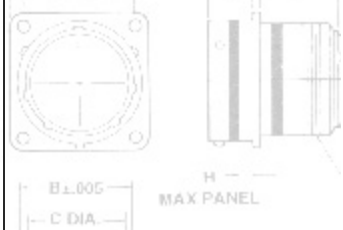
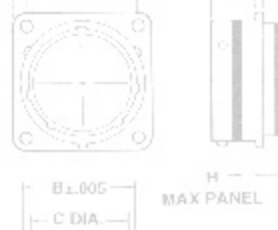
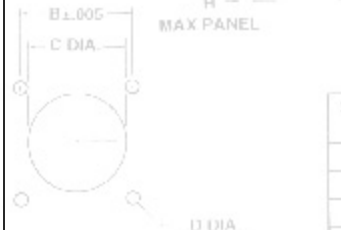
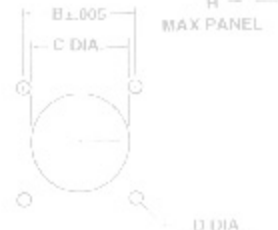
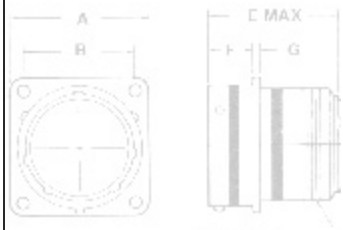
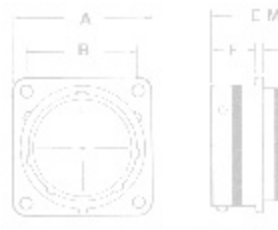

24-31	1 0	90	225	255	312	1 5/16	8 UNF
24-61	0	90	180	270	324		I

For pricing and availability, please fill out our RFQ form



If you need any other information, please [E-Mail aecs@aecsinc.com](mailto:aecs@aecsinc.com)



phone (703) 425-3815 fax (703) 425-38147

We look forward to hearing from you!

SHELL	A	B	C	D	E	F	G	J
5477	MAX	±.005	±.002	±.006	MAX	-.015	+.011	3/4-24 UNF
8	828	564	568	120	1.215	446	862	1.25 UNF
10	964	719	685	120	1.215	446	862	5/8-24 UNF
12	1099	864	803	120	1.215	446	862	1.25 UNF
14	1.234	998	1.115	120	1.215	446	862	1.25 UNF
16	1.378	1.098	1.235	120	1.215	446	862	1.1875-8 UNF
18	1.522	1.202	1.355	120	1.215	446	862	1.1875-8 UNF
22	1.878	1.560	1.485	120	1.275	572	894	1.5/16-8 UNF
24	1.708							1.7/16-8 UNF



A Woman Owned Small Business, CAGE Code 07BG6

Copyright © 2008 Allen Electric Connector Sales, Inc. All Rights Reserved.