



Allen Electric Connector Sales, inc.



MIL-DTL-26482 Series II



The MIL-DTL-26482 Series II bayonet connectors are available in nine shell sizes with a choice of narrow or wide flanges, jam nut and cable connecting receptacles, and with RFI or standard plugs. These bayonet connectors are available in 49 insert arrangements, 20, 16, and 12 gauge contact sizes terminate wire gauges 24 through 12. The fluorosilicone resilient elastomers provide superior interface protection when exposed to a wide variety of fluids. The rear grommets incorporate redundant rear wiper seals around each wire. The hard plastic socket interface features the chamfered conical entry aiding in proper contact mating. The non-conductive black anodize surface treatment on the aluminum shells makes an exceptionally hard finish that prolongs the life of the connector.

GENERAL SPECIFICATIONS

Environmental Fluorosilicone Elastomers ^D	Operating Temperature Range: -55 degrees C (-67 degrees F) to 200 degrees C (392 degrees F)
Polarization: Insert Rotation	Voltage Service Rating: Service Rating I: 600 VAC at Sea Level, 300 VAC at 70,000 ft, Service Rating II: 1000 VAC at Sea Level, 450 VAC at 70,000 ft.
Contacts: Crimp type, Sizes 20, 16, and 12 gauge per MIL-C-39029	

CONTACT INFORMATION

Contact Size	Socket Contacts	Pin Contacts	Crimp Tool	Positioner or Turret	Sealing Plugs
12	M39029/5-	M39029/4-113	M22520/1-	M22520/1-02	MS27488-12

	118		01		
16	M39029/5-116	M39029/4-111	M22520/1-01	M22520/1-02	MS27488-16
20	M39029/5-115	M39029/4-110	M22520/1-01	M22520/1-02	MS27488-20

MILITARY PART NUMBERING SYSTEM

MS3474

S

14 - 04

S

X

- Polarization (Blank for normal, Alternate positions W, X, Y or Z)**
- Contact Style: P= Pins, S= Sockets, A= less Pins, B= less Sockets**
- Insert Arrangement: Per MIL-STD-1669**
- Shell Size: Even numbers 8 thru 24**
- Class:**
 - L = Aluminum shell, electroless nickel finish**
 - A = Aluminum shell, anodized finish, black (not applicable to MS3475)**
 - S = Stainless steel, passivated**
 - W = Aluminum shell, olive drab cadmium plated**
- MS Number:**
 - MS3470 Narrow flange receptacle**
 - MS3471 Cable connecting receptacle**
 - MS3472 Wide flange receptacle**
 - MS3474 Jam nut mount receptacle**
 - MS3475 RFI grounding Plug**
 - MS3476 Standard Plug**

[MIL-DTL-26482 Series II Polarizing Positions](#)

[MIL-DTL-26482 Insert Arrangements](#)

[MIL-DTL-26482 Type Rear Release Plugs](#)

[MS3470 Receptacle, Narrow Flange MTG., Bayonet Coupling, Class A, L, S, W](#)

[MS3471 Receptacle, Cable Connecting, Bayonet Coupling, Class A, L, S, W](#)

[MS3472 Receptacle, Wide Flange MTG., Bayonet Coupling, Class A, L, S, W](#)

[MS3474 Receptacle, Single Hole MTG., Bayonet Coupling, Class A, L, S, W](#)

[MS3475 Plug, RFI, Bayonet Coupling, Class L, S, W](#)

[MS3476 Plug, Bayonet Coupling, Class A, L, S, W](#)

For pricing and availability, please fill out our RFQ form



If you need any other information, please [E-Mail aecs@aecsin.com](mailto:aecs@aecsin.com)

phone (703) 425-3815 fax (703) 425-3814

We look forward to hearing from you!



Allen Electric Connector Sales, inc.



TM

MIL-DTL-26482 SERIES II POLARIZING POSITIONS

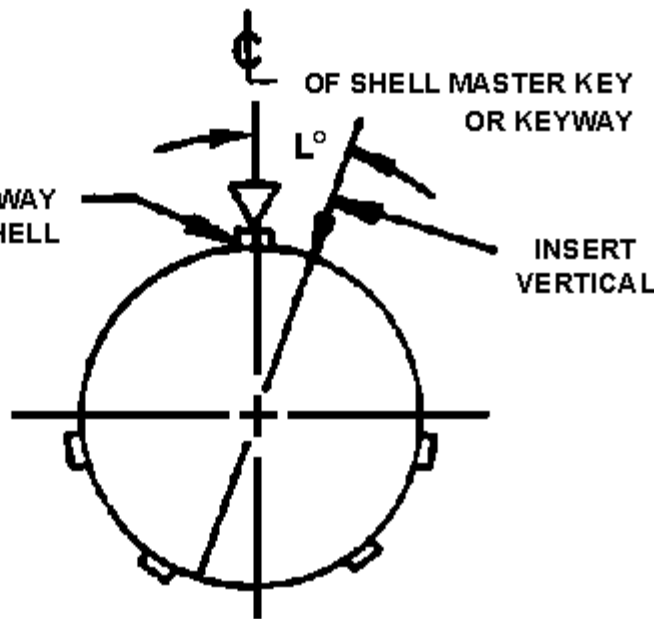

The normal position (N) has the insert centerline that coincides with the centerline of the master keyway of the shell. The alternate clocking positions (W,X,Y, and Z) are done by rotating the pin insert clockwise. The socket insert is rotated counter clockwise. The drawing above shows the insert rotation clockwise with the tables showing the degree of

SHELL SIZE	A	B	C	D	E	F	G	H	J
8-2	MAX	±0.05	±0.02	±0.03	MAX	-0.1	+0.10	MAX	1/4-20 UNF
8-3									5/8-24 UNF
8-4									3/4-20 UNF
8-33									7/8-20 UNF
8-98 ^{AD}									1-20 UNF
10-6									1 1/16-18 UNF
10-98									1 3/16-18 UNF
12-3									1 5/16-18 UNF
12-8									1 7/8-18 UNF
12-10									2-18 UNF
14-4									2 1/2-18 UNF
14-5									2 7/8-18 UNF

Shell Size	A	B	C	D	E	F	G	H	J
10	954	719	585	120	1215	440	052	087	5/8-24 UNF
12	1047	812	664	120	1215	440	052	087	3/4-20 UNF
14	1141	906	769	120	1215	440	052	087	7/8-20 UNF
16	1234	980	1115	120	1215	440	052	087	1-20 UNF
18	1328	1072	1235	120	1215	440	052	087	1 1/16-18 UNF
20	1422	1160	1365	120	1215	440	052	087	1 3/16-18 UNF

SHELL SIZE & INSERT ARRANGEMENT	L DEGREES					Service Rating
	N	W	X	Y	Z	
8-2	0	58	122	-	0	I
8-3	0	60	210	-	-	I
8-4	0	45	-	-	-	I
8-33	0	90	-	-	-	I
8-98 ^{AD}	0	-	-	-	-	I
10-6	0	90	-	-	-	I
10-98	0	90	180	240	270	I
12-3	0	90	112	203	292	I
12-8	0	90	112	203	292	I
12-10	0	60	155	270	295	I
14-4	0	45	92	184	273	I
14-5	0	40	92	184	273	II

rotation.

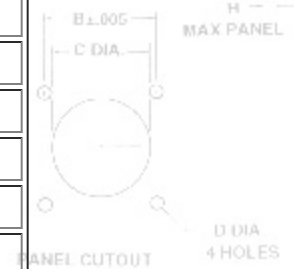
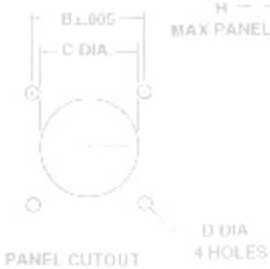
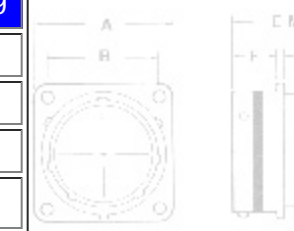
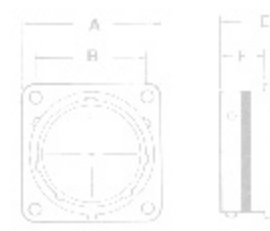
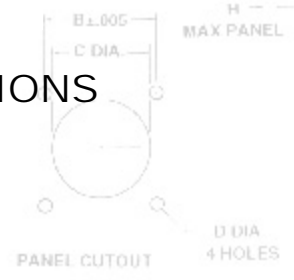

14-9	0	15	90	180	240	I				
14-12	0	43	90	-	-	I				
14-15	0	17	110	155	234	I				
14-18	0	15	90	180	270	I				
SHELL SIZE & INSERT ARRANGEMENT	L DEGREES					Service Rating				
	N	W	X	Y	Z					
14-19	0	30	165	315	-	I				
14-22	0	45	-	-	-	I				
16-8	0	54	152	180	331	II				
16-14	0	25	78	180	240	I				
16-23	0	158	270	-	-	I				
16-26	0	60	125	275	338	I				
16-95	0	25	90	153	-	I				
16-99	0	66	156	223	340	I				
18-8	0	180	-	-	-	I				
18-11	0	62	119	241	340	II				
18-30	0	180	193	285	350	I				
18-32	0	85	138	222	265	I				
18-85	0	45	90	180	240	I				
18-88	0	12	45	168	202	I				
20-16	0	238	318	333	347	II				
20-24	0	70	145	215	290	I				
SHELL SIZE & INSERT ARRANGEMENT	L DEGREES					Service Rating				
	N	W	X	Y	Z					
20-27	0	72	144	216	288	I				
20-39	0	63	144	252	333	I				
20-41	0	45	126	225	-	I				
20-90	0	18	60	240	270	I				
22-12	0	-	-	-	-	I				
22-19	0	15	90	225	308	I				
22-21	0	16	135	175	349	II				
22-32	0	72	145	215	288	I				
22-34	0	62	142	218	298	I				
22-41	0	39	135	264	-	I				
22-55	0	30	142	226	314	I				
22-95	0	26	180	266	-	I				
22-96	0	19	41	-	-	I				
24-19	0	30	165	315	-	II				
24-27	0	45	110	140	225	I				
22	1	50	485	1275	72	094	312	1511	18	LINE

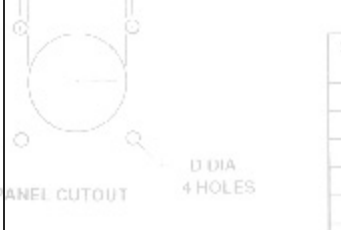
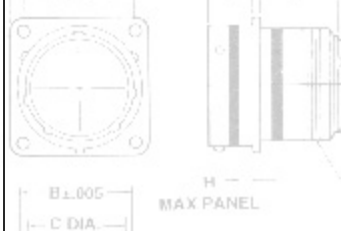
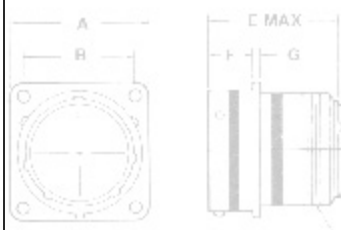
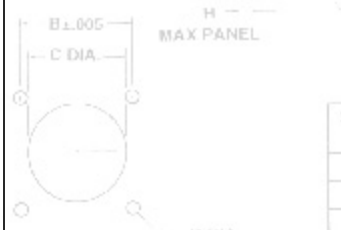
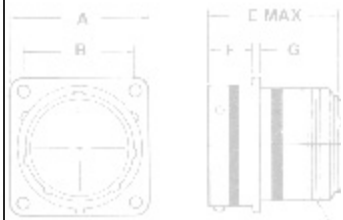
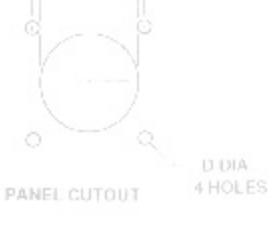
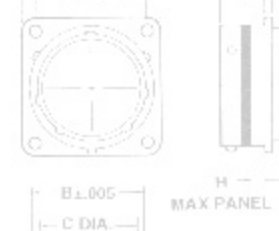
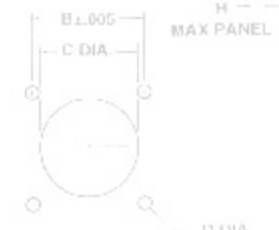
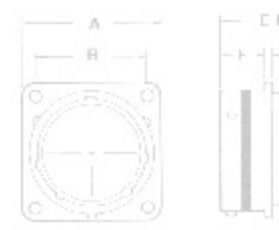
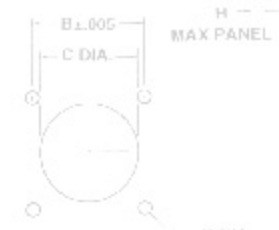
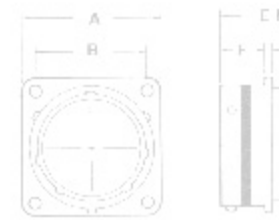

24-31	1 0	90	225	255	312	1 5/16	8 UNF
24-61	0	90	180	270	324		I

For pricing and availability, please fill out our RFQ form



If you need any other information, please [E-Mail aecs@aecsinc.com](mailto:aecs@aecsinc.com)



phone (703) 425-3815 fax (703) 425-38147

We look forward to hearing from you!



A Woman Owned Small Business, CAGE Code 07BG6

Copyright © 2008 Allen Electric Connector Sales, Inc. All Rights Reserved.

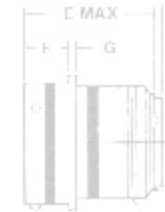
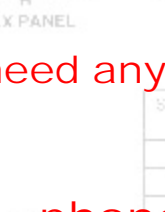
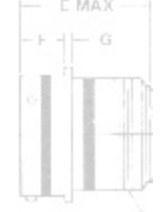

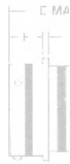

TM

**Allen Electric
Connector Sales, Inc.**



H
MAX PANEL

MIL-DTL-26482 SERIES II INSERT ARRANGEMENTS

SHELL SIZE	A MAX	B ±.005	C ±.005	D ±.005	E MAX	F -0° ±	G +.010	H MAX	J THREAD 2A
14	1.234	.968	1.115	.720	1.215	.446	.002	.587	1 1/16-18 UNF
16	1.328	1.062	1.235	.720	1.215	.446	.002	.587	1 1/16-18 UNF



H
MAX PANEL

J THREAD

SHELL SIZE	A MAX	B ±.005	C ±.005	D ±.005	E MAX	F -0° ±
14	1.234	.968	1.115	.720	1.215	.446
16	1.328	1.062	1.235	.720	1.215	.446

Insert arrangement numbers are made by combining shell size (first two numbers) and the insert arrangement number (last two numbers). For example, a MS3476W14-12P would be shell size 14 with a insert of 12 for a 1412 insert arrangement. Insert arrangements are shown in numerical order by shell size and number of contacts in each shell size.

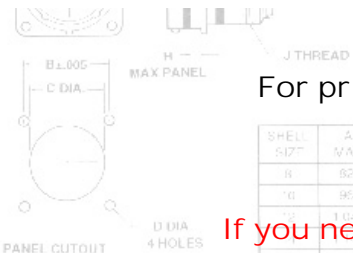
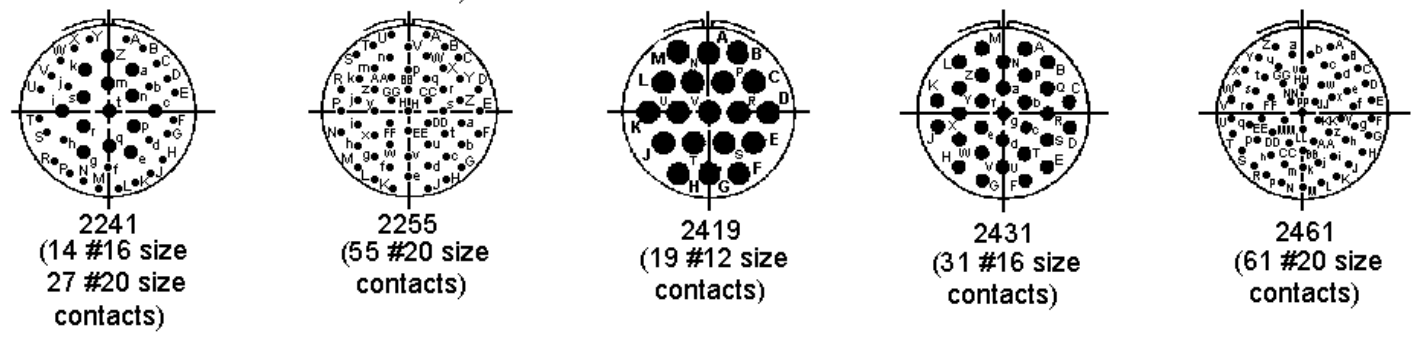
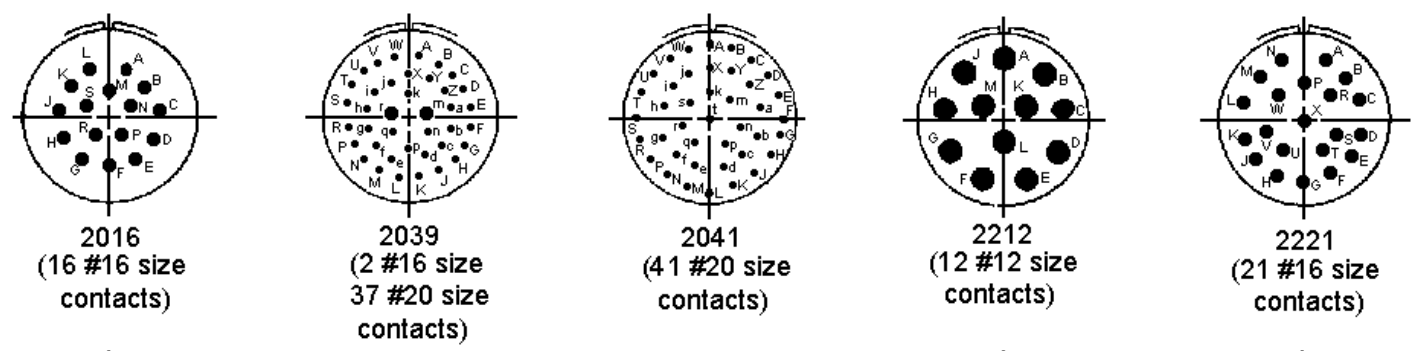
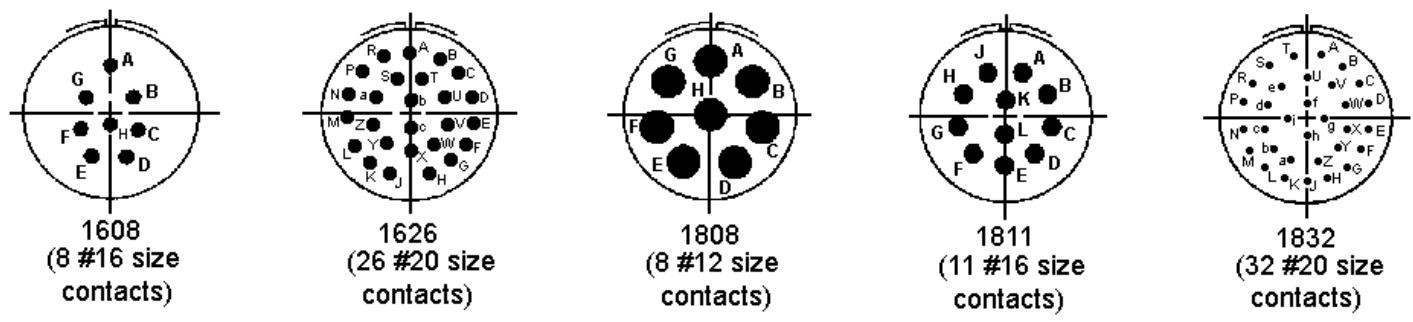
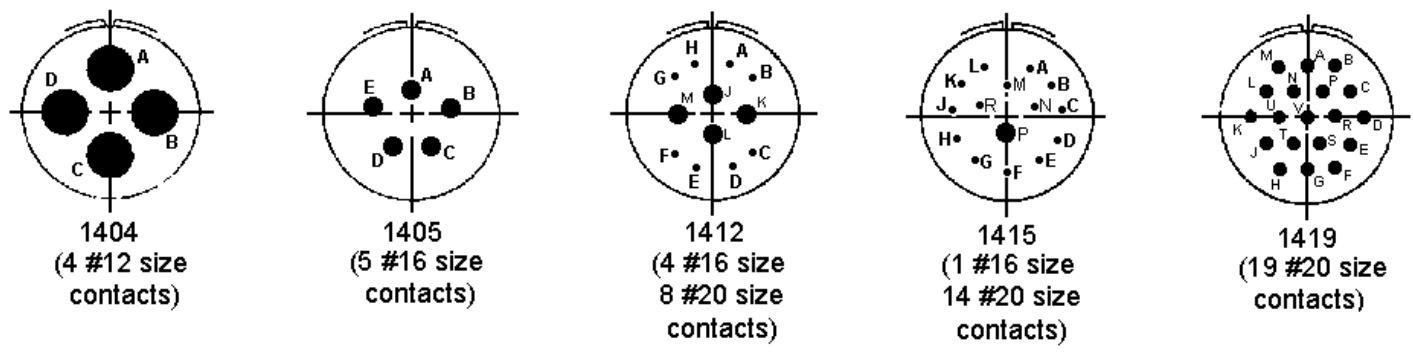
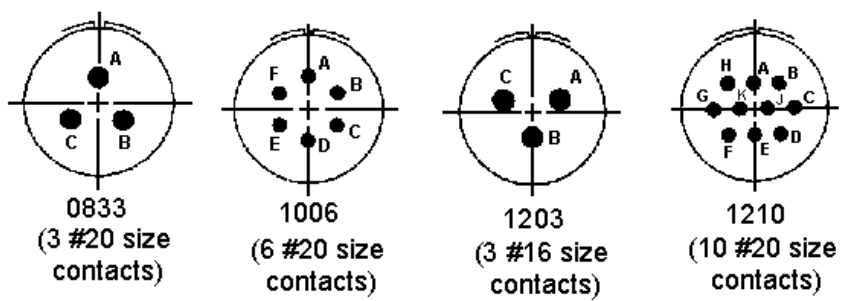

For pricing and availability, please fill out our RFQ form



SHELL SIZE	A	B	C	D	E	F	G	H	J
MAX	±.005	±.005	±.005	MAX	±.010	±.010	MAX	TH-LEAD DIA	
B	520	554	568	120	121.5	445	552	657	1/2 20 UNF
D	954	719	585	120	121.5	445	552	657	1/2 20 UNF
H	1047	822	673	120	121.5	445	552	657	1/2 20 UNF
J	1234	958	1112	20	121.5	445	552	657	1/2 20 UNF



If you need any other information, please

aecs@aecsinc.com



SHELL SIZE	A	B	C	U	E	F
10	954	719	585	120	1.215	446
12	1047	812	584	120	1.215	446
14	1141	906	589	120	1.215	446
16	1234	998	1115	120	1.215	446
18	1328	1092	1235	120	1.215	446
20	1423	1188	1363	120	1.275	512
22	1518	1285	1485	120	1.275	512
24	1703	1375	1615	147	1.275	512



SHELL SIZE	A	B	C	U	E	F
10	954	719	585	120	1.215	446
12	1047	812	584	120	1.215	446
14	1141	906	589	120	1.215	446
16	1234	998	1115	120	1.215	446
18	1328	1092	1235	120	1.215	446
20	1423	1188	1363	120	1.275	512
22	1518	1285	1485	120	1.275	512
24	1703	1375	1615	147	1.275	512

phone (703) 425-3815 fax (703) 425-3814

We look forward to hearing from you!



A Woman Owned Small Business, CAGE Code 07BG6

Copyright © 2008 Allen Electric Connector Sales, Inc. All Rights Reserved.

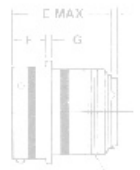

$\pm .005$
.190

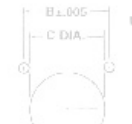

H — MAX PANEL
J THREAD

SHELL SIZE	A	B	C	U	E	F
10	828	554	568	120	1.215	446

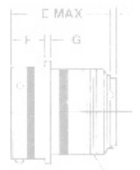

$\pm .005$
.190

H — MAX PANEL
J THREAD

SHELL SIZE	A	B	C	U	E	F
10	828	554	568	120	1.215	446



**Allen Electric
Connector Sales, inc.**



MIL-DTL-26482 TYPE REAR RELEASE PLUGS

(INTERMATEABLE WITH MIL-DTL-26482 SOLDER PIN RECEPTACLES)

SHELL SIZE	A	B	C	D	E	F	G	H	J
6	1.047	0.812	0.864	1.20	1.215	4.46	0.62	0.87	3/4-20 UNEF
8	1.143	0.906	0.958	1.20	1.215	4.46	0.62	0.87	7/8-20 UNEF
12	1.047	0.812	0.864	1.20	1.215	4.46	0.62	0.87	1-20 UNEF
14	1.234	0.980	1.115	1.20	1.215	4.46	0.62	0.87	1-20 UNEF
18	1.328	1.032	1.136	1.20	1.215	4.46	0.62	0.87	1-1/16-18 UNLF
20	1.413	1.100	1.205	1.20	1.275	5.02	0.94	0.94	1-3/16-18 UNLF
22	1.578	1.250	1.485	1.20	1.275	5.02	0.94	0.94	1-5/16-18 UNLF
24	1.709	1.375	1.615	1.27	1.275	5.02	0.94	0.94	1-7/16-18 UNLF

SPECIALS



0802

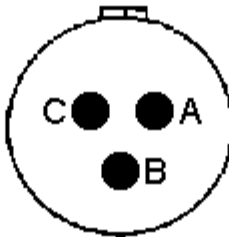

0803

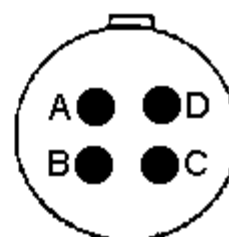

0804

The three insert arrangement layouts shown are identical to the MIL-DTL-26482 Series II, but are not qualified to the specification. The shell configuration has been slightly altered to allow these rear release, crimp contacts plugs to intermate with the applicable MIL-DTL-26482 Series I solder pin receptacles. The special design originated for NASA and is used by various commercial aircraft avionics and payload equipment applications. Their #20 gauge pin and socket contacts are not qualified to the MIL-C-39029 specification, but use the same crimp tooling, insertion and removal tools.

Size 20 Contacts	Crimp Tool	Turret	Insertion/Extraction Tool
Socket: AE 5091-022-2020 Pin: AE 5291-022-2020	M22520/1-01 or M22520/2-01	M22520/1-02 or M22520/2-02	M81969/14-01

For pricing and availability, please fill out our RFQ form



If you need any other information, please aecs@aecsinc.com

18	1.328	1.062	1.235	.20	1.215	.446	.062	.087	1/8 UNF
20	1.443	1.166	1.363	.20	1.275	.522	.094	.094	1/8 UNF
22	1.578	1.290	1.485	.20	1.275	.522	.094	.094	1/8 UNF
24	1.703	1.375	1.615	.27	1.275	.504	.094	.094	1/8 UNF



phone (703) 425-3815 fax (703) 425-3814

We look forward to hearing from you!



SHELL SIZE	A MAX	B ±.005	C ±.005	D DIA	E DIA	F DIA	G MAX	H MAX	J THREAD
8	.828	.554	.568	.120	1.215	.446	.052	.087	1/2-20 UNF
12	1.047	.812	.824	.120	1.215	.446	.062	.087	3/4-20 UNF
14	1.141	.906	.969	.120	1.215	.446	.062	.087	7/8-20 UNF
18	1.328	1.062	1.235	.20	1.215	.446	.062	.087	1 1/16-18 UNF
20	1.443	1.166	1.363	.20	1.275	.522	.094	.094	1 1/8-18 UNF
22	1.578	1.290	1.485	.20	1.275	.522	.094	.094	1 1/8-18 UNF
24	1.703	1.375	1.615	.27	1.275	.504	.094	.094	1 1/8-18 UNF

A Woman Owned Small Business, CAGE Code 07BG6

Copyright © 2008 Allen Electric Connector Sales, Inc. All Rights Reserved.

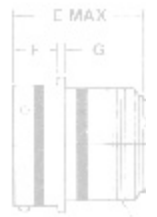
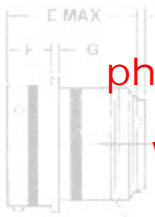

H MAX PANEL

J THREAD

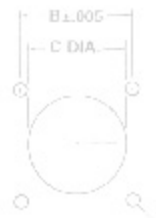

H MAX PANEL

PANEL CUTOUT

D DIA 4 HOLES

PANEL CUTOUT

D DIA 4 HOLES



Allen Electric Connector Sales, Inc.



TM

MS3470 RECEPTACLE, NARROW FLANGE MOUNTING,
BAYONET COUPLING, CLASS A, L, S, W

SHELL SIZE	MAX	+-.005	+-.005	+-.005	MAX	+-.010	+-.010	MAX	THREAD
8	.828	.594	.568	.120	1.215	.446	.062	.087	1/2-20 UNF
10	.964	.719	.685	.120	1.215	.446	.062	.087	5/8-24 UNF
12	1.047	.812	.864	.120	1.215	.446	.062	.087	3/4-20 UNF
14	1.141	.906	.989	.120	1.215	.446	.062	.087	7/8-20 UNF

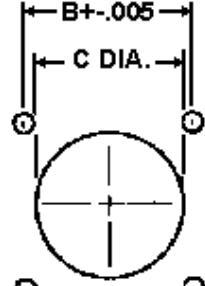
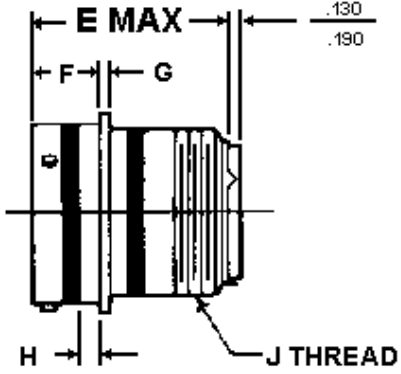
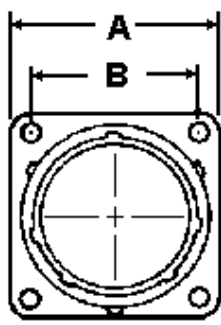
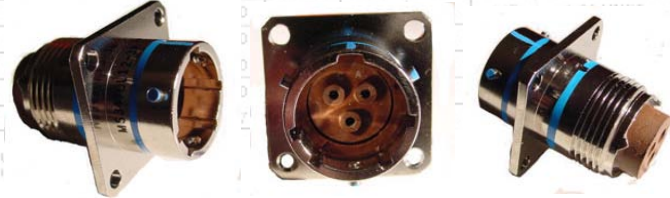

MAX PANEL

PANEL CUTOUT

D DIA. 4 HOLES

SHELL SIZE	A MAX	B +-.005	C +-.005	D +-.005	E MAX	F +-.010	G +-.010	H MAX	J THREAD-2A
8	.828	.594	.568	.120	1.215	.446	.062	.087	1/2 20 UNF
10	.964	.719	.685	.120	1.215	.446	.062	.087	5/8-24 UNF
12	1.047	.812	.864	.120	1.215	.446	.062	.087	3/4-20 UNF
14	1.141	.906	.989	.120	1.215	.446	.062	.087	7/8-20 UNF

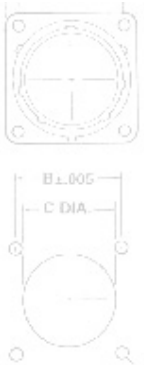

16	1.234	.969	1.113	.120	1.215	.446	.062	.087	1-20 UNEF
18	1.328	1.062	1.238	.120	1.215	.446	.062	.087	1 1/16-18 UNEF
20	1.453	1.156	1.363	.120	1.275	.572	.094	.212	1 3/16-18 UNEF
22	1.578	1.250	1.488	.120	1.275	.572	.094	.212	1 5/16-18 UNEF
24	1.703	1.375	1.615	.147	1.275	.604	.094	.212	1 7/16-18 UNEF

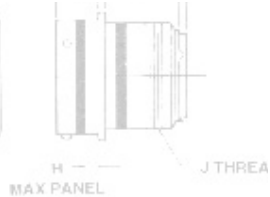

[MIL-DTL-26482 Series II Polarizing Positions](#)
[MIL-DTL-26482 Series II Insert Arrangements](#)

20	1.448	1.150	1.365	.120	1.275	.572	.094	.212	1 3/16-18 UNEF
----	-------	-------	-------	------	-------	------	------	------	----------------

SHELL SIZE	3
8	1
16	1
18	1
20	1

MILITARY PART NUMBERING SYSTEM

MS3470

L 14 - 04 P W

- Polarization** (Blank for normal, Alternate positions W, X, Y or Z)
- Contact Style:** P= Pins, S= Sockets, A= less Pins, B= less Sockets
- Insert Arrangement:** Per MIL-STD-1669
- Shell Size:** Even numbers 8 thru 24
- Class:**
 - L = Aluminum shell, electroless nickel finish
 - A = Aluminum shell, anodized finish, black (not applicable to MS3475)
 - S = Stainless steel, passivated
 - W = Aluminum shell, olive drab cadmium plated
- MS Number:** MS3470 Narrow flange receptacle
 MS3471 Cable connecting receptacle
 MS3472 Wide flange receptacle
 MS3474 Jam nut mount receptacle
 MS3475 RFI grounding Plug
 MS3476 Standard Plug

22	1.578	1.250	1.488	.120	1.275	.572	.094	.212	1 5/16-18 UNEF
24	1.703	1.375	1.615	.147	1.275	.604	.094	.212	1 7/16-18 UNEF

For pricing and availability, please fill out our RFQ form



If you need any other information, please **E-Mail** aecs@aecsinc.com



phone (703) 425-3815 fax (703) 425-3814

We look forward to hearing from you!



A Woman Owned Small Business, CAGE Code 07BG6



Allen Electric Connector Sales, inc.



MS3471 RECEPTACLE, CABLE CONNECTING, BAYONET COUPLING, CLASS A, L, S, W

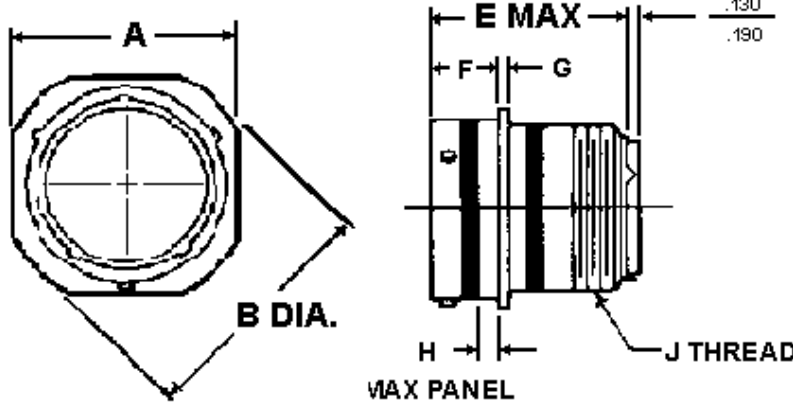

SHELL SIZE	A MAX	B $\pm .030$	E MAX	F $\pm .015$	G $\pm .010$	J THREAD-2A
8	.828	.948	1.215	.446	.062	1/2 20 UNF
10	.954	1.072	1.215	.446	.062	5/8-24UNEF
12	1.047	1.166	1.215	.446	.062	3/4-20 UNEF
14	1.141	1.260	1.215	.446	.062	7/8-20 UNEF
16	1.234	1.354	1.215	.446	.062	1-20 UNEF
18	1.328	1.448	1.215	.446	.062	1 1/16-18 UNEF
20	1.453	1.572	1.275	.572	.094	1 3/16-18 UNEF
22	1.578	1.898	1.275	.572	.094	1 5/16-18 UNEF
24	1.703	2.822	1.275	.604	.094	1 7/16-18 UNEF

MILITARY PART NUMBERING SYSTEM

MS3471

A

14 - 04

P

Y

- Polarization (Blank for normal, Alternate positions W, X, Y or Z)
- Contact Style: P= Pins, S= Sockets, A= less Pins, B= less Sockets
- Insert Arrangement: Per MIL-STD-1669
- Shell Size: Even numbers 8 thru 24
- Class:
 - L = Aluminum shell, electroless nickel finish
 - A = Aluminum shell, anodized finish, black (not applicable to MS3475)
 - S = Stainless steel, passivated
 - W = Aluminum shell, olive drab cadmium plated
- MS Number: MS3470 Narrow flange receptacle
- MS3471 Cable connecting receptacle
- MS3472 Wide flange receptacle
- MS3474 Jam nut mount receptacle
- MS3475 RFI grounding Plug
- MS3476 Standard Plug

For pricing and availability, please fill out our RFQ form



If you need any other information, please [E-Mail aecs@aecsinc.com](mailto:aecs@aecsinc.com)

phone (703) 425-3815 fax (703) 425-3814

We look forward to hearing from you!



A Woman Owned Small Business, CAGE Code 07BG6

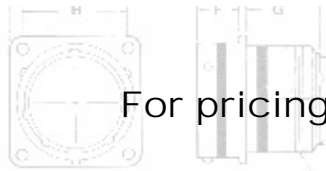

H — J THREAD
MAX PANEL



PANEL CUTOUT
D DIA
4 HOLES



H — J THREA
MAX PANEL



PANEL CUTOUT
D DIA
4 HOLES

SIZ	MAX	±.005	±.005	±.005	MAX	±.015	±.010	V	A
8	828	554	568	120	1.215	446	052	1	16
10	954	718	685	100	1.215	446	052	1	16
12	1147	906	869	120	1.215	446	062	087	7/8-20 UNEF
14	1234	986	1115	120	1.215	446	062	087	1-20 UNEF
16	1463	1100	1265	120	1.215	572	094	122	1-3/16-18 UNEF
20	1578	1250	1486	120	1.215	572	094	112	1-5/16-18 UNEF
24	1703	1375						112	1-1/2-18 UNF

SHELL	SIZ	A
B	16	1
	16	1
	18	1
	18	1
	20	1
	20	1
	22	1
	24	1

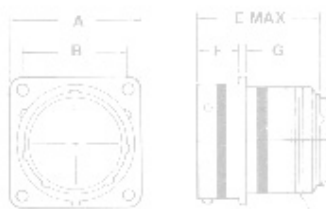

B ±.005
MAX PANEL

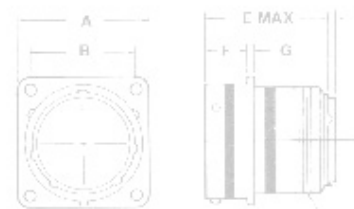

B ±.005
MAX PANEL



Allen Electric Connector Sales, inc.



MS3472 RECEPTACLE, WIDE FLANGE MTG.,
BAYONET COUPLING, CLASS A, L, S, W

SHELL SIZE	A MAX	B ±.005	C ±.005	D ±.005	E MAX	F ±.015	G ±.010	H MAX	J THREAD-2A
8	1.047	.732	.564	.120	1.215	.446	.062	.087	3/4-20 UNF
10	1.141	.806	.669	.120	1.215	.446	.062	.087	7/8-20 UNF
12	1.234	.880	.743	.120	1.215	.446	.062	.087	1-20 UNF
14	1.328	1.002	.865	.120	1.215	.446	.062	.087	1 1/16-18 UNF

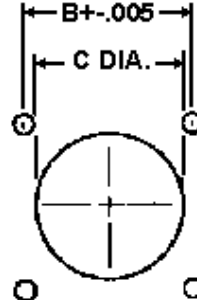
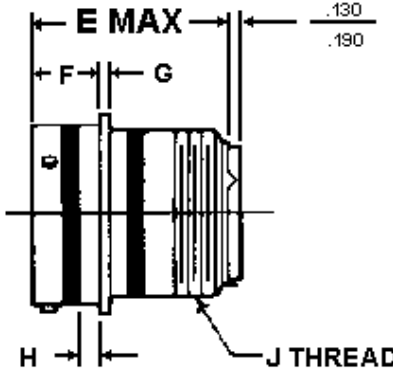
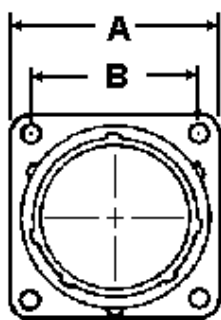

SHELL SIZE	A MAX	B ±.005	C ±.005	D ±.005	E MAX	F ±.015	G ±.010	H MAX	J THREAD-2A
8	1.065	.734	.568	.150	1.215	.477	.062	.118	1/2 20 UNF
10	1.141	.812	.685	.150	1.215	.477	.062	.118	5/8-24 UNF
12	1.256	.938	.864	.150	1.215	.477	.062	.118	3/4-20 UNF
14	1.360	1.031	.989	.150	1.215	.477	.062	.118	7/8-20 UNF
16	1.453	1.125	1.113	.150	1.215	.477	.062	.118	1-20 UNF
18	1.532	1.203	1.238	.150	1.215	.477	.062	.118	1 1/16-18

										UNEF
20	1.688	1.297	1.363	.150	1.275	.571	.094	.212		1 3/16-18 UNEF
22	1.766	1.375	1.488	.150	1.275	.571	.094	.212		1 5/16-18 UNEF
24	1.891	1.500	1.615	.150	1.275	.604	.094	.212		1 7/16-18 UNEF

[MIL-DTL-26482 Series II Polarizing Positions](#)
[MIL-DTL-26482 Series II Insert Arrangements](#)

MILITARY PART NUMBERING SYSTEM

MS3472

W

18 - 32

P

Y

- Polarization** (Blank for normal, Alternate positions W, X, Y or Z)
- Contact Style:** P= Pins, S= Sockets, A= less Pins, B= less Sockets
- Insert Arrangement:** Per MIL-STD-1669
- Shell Size:** Even numbers 8 thru 24
- Class:**
 - L = Aluminum shell, electroless nickel finish
 - A = Aluminum shell, anodized finish, black (not applicable to MS3475)
 - S = Stainless steel, passivated
 - W = Aluminum shell, olive drab cadmium plated

MS Number: MS3470 Narrow flange receptacle

MS3471 Cable connecting receptacle

MS3472 Wide flange receptacle

MS3474 Jam nut mount receptacle

MS3475 RFI grounding Plug

MS3476 Standard Plug

For pricing and availability, please fill out our RFQ form



If you need any other information, please [E-Mail aecs@aecsinc.com](mailto:aecs@aecsinc.com)

phone (703) 425-3815 fax (703) 425-3814

We look forward to hearing from you!



A Woman Owned Small Business, CAGE Code 07BG6



Allen Electric Connector Sales, Inc.

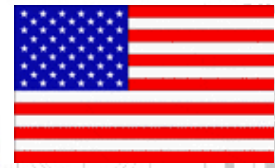

MS3474 RECEPTACLE, SINGLE HOLE MTG., BAYONET COUPLING, CLASS A, L, S, W

SHELL SIZE	A	B	C	D	E	F	G	H	J
507	1.141	1.062	1.095	1.20	1.215	1.40	0.062	0.087	7/8-20 UNEF
10	1.234	1.166	1.115	1.20	1.215	1.46	0.062	0.087	1-20 UNEF



SHELL SIZE	A	B	C	D	E	F	G	H	J
10	1.141	1.062	1.095	1.20	1.215	1.40	0.062	0.087	7/8-20 UNEF
16	1.234	1.166	1.115	1.20	1.215	1.46	0.062	0.087	1-20 UNEF

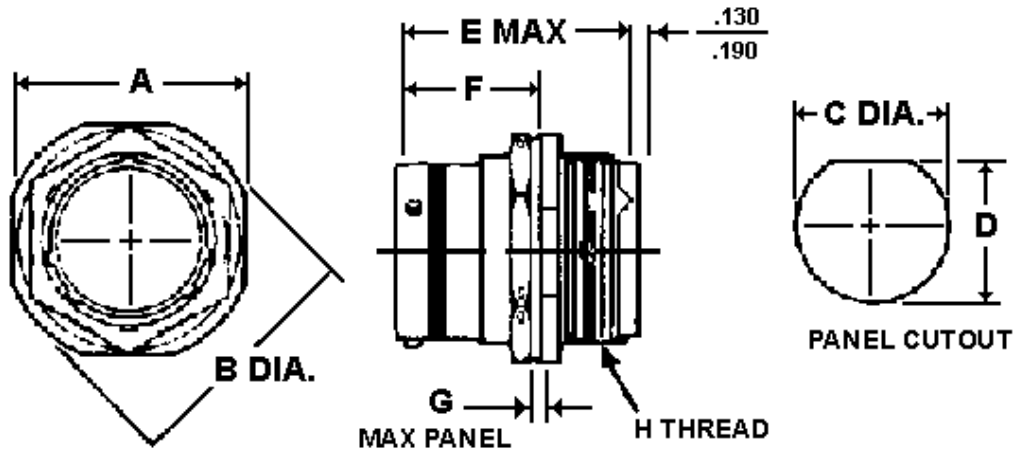
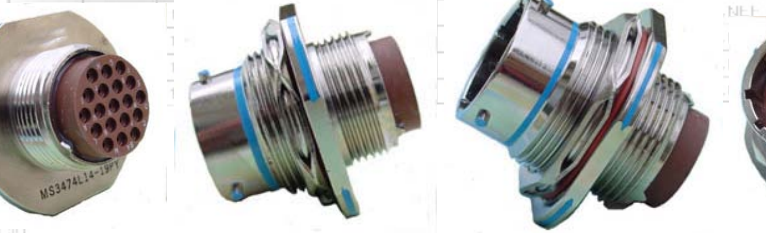

SHELL SIZE	A +.015	B +.015	C +.005	D +.005	E MAX	F +.010	G MAX	J THREAD-2A
8	.938	1.063	.572	.536	1.215	.656	.187	1/2 20 UNF
10	1.063	1.187	.697	.661	1.215	.656	.187	5/8-24 UNEF
12	1.250	1.346	.895	.824	1.215	.656	.187	3/4-20 UNEF
14	1.346	1.500	1.010	.984	1.215	.656	.187	7/8-20 UNEF
16	1.500	1.625	1.135	1.072	1.215	.656	.187	1-20 UNEF
18	1.625	1.750	1.260	1.197	1.215	.656	.187	1 1/16-18 UNEF
20	1.812	1.938	1.385	1.322	1.275	.719	.250	1 3/16-18 UNEF
22	1.938	2.063	1.510	1.447	1.275	.719	.250	1 5/16-18 UNEF
24	2.063	2.187	1.635	1.572	1.275	.719	.219	1 7/16-18 UNEF

[MIL-DTL-26482 Series II Polarizing Positions](#)
[MIL-DTL-26482 Series II Insert Arrangements](#)

MILITARY PART NUMBERING SYSTEM

MS3474

S

14 - 04

S

X

- Polarization** (Blank for normal, Alternate positions W, X, Y or Z)
- Contact Style:** P= Pins, S= Sockets, A= less Pins, B= less Sockets
- Insert Arrangement:** P er MIL-STD-1669
- Shell Size:** Even numbers 8 thru 24
- Class:**
 - L = Aluminum shell, electroless nickel finish
 - A = Aluminum shell, anodized finish, black (not applicable to MS3475)
 - S = Stainless steel, passivated
 - W = Aluminum shell, olive drab cadmium plated
- MS Number:** MS3470 Narrow flange receptacle
MS3471 Cable connecting receptacle
MS3472 Wide flange receptacle
MS3474 Jam nut mount receptacle
MS3475 RFI grounding Plug
MS3476 Standard Plug

For pricing and availability, please fill out our RFQ form



If you need any other information, please [E-Mail aecs@aecsinc.com](mailto:aecs@aecsinc.com)



phone (703) 425-3815 fax (703) 425-3814

We look forward to hearing from you!



A Woman Owned Small Business, CAGE Code 07BG6

Copyright © 2008 Allen Electric Connector Sales, Inc. All Rights Reserved.

SHELL SIZE	A MAX	B ±.005	C ±.005	D ±.005	E MAX	F -0.05	G +0.10	H MAX	J THREAD 2A
10	954	719	685	120	1215	446	052	087	5/8-24 UNF



Allen Electric Connector Sales, inc.



MS3475 PLUG, RFI, BAYONET COUPLING, CLASS L, S, W

SHELL SIZE	A MAX	B	B	MAX	-0°C	+0°C	MAX	TH-HEAD 2A
8	.828	.564	.568	120	445	055	087	1/2-20 UNF
10	.954	.719	.625	120	445	055	087	5/8-24 UNEF
12	1.047	.812	.664	120	448	062	087	3/4-20 UNEF

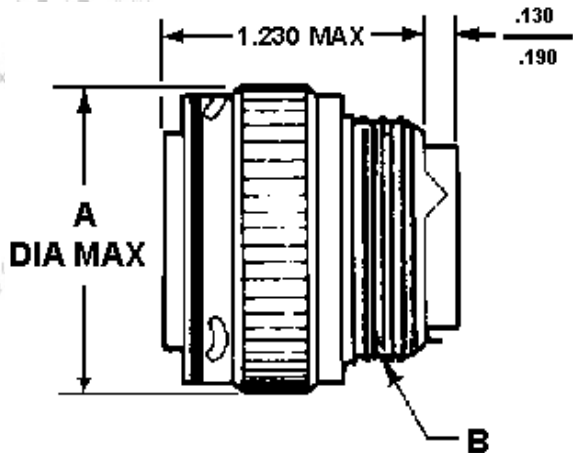

SHELL SIZE	A MAX	B THREAD-2A
8	.782	1/2-20 UNF
10	.926	5/8-24 UNEF
12	1.043	3/4-20 UNEF
14	1.183	7/8-20 UNEF
16	1.305	1-20 UNEF
18	1.391	1 1/16-18 UNEF
20	1.531	1 3/16-18 UNEF
22	1.656	1 5/16-18 UNEF
24	1.777	1 7/16-18 UNEF

[MIL-DTL-26482 Series II Polarizing Positions](#)
[MIL-DTL-26482 Insert Arrangements](#)

MILITARY PART NUMBERING SYSTEM

MS3475

L

18 - 32

P

W

- Polarization (Blank for normal, Alternate positions W, X, Y or Z)
- Contact Style: P= Pins, S= Sockets, A= less Pins, B= less Sockets
- Insert Arrangement: Per MIL-STD-1669
- Shell Size: Even numbers 8 thru 24
- Class:
 - L = Aluminum shell, electroless nickel finish
 - A = Aluminum shell, anodized finish, black (not applicable to MS3475)
 - S = Stainless steel, passivated
 - W = Aluminum shell, olive drab cadmium plated

- MS Number: MS3470 Narrow flange receptacle
- MS3471 Cable connecting receptacle
- MS3472 Wide flange receptacle
- MS3474 Jam nut mount receptacle
- MS3475 RFI grounding Plug
- MS3476 Standard Plug



For pricing and availability, please fill out our RFQ form



SHELL SIZE	A MAX	B ±.005	C ±.005	D ±.005	E MAX	F -0° ±	G +0.10	H MAX	J TH-HEAD 2A
8	.628	.564	.568	.120	1.215	.446	.052	.087	1/2-20 UNF
10	1.047	.612	.564	.120	1.215	.446	.052	.087	3/4-20 UNEF
12	1.147	.906	.969	.120	1.215	.446	.062	.087	7/8-20 UNEF
16	1.234	.960	1.115	.120	1.215	.446	.062	.087	1-20 UNEF
18	1.338	1.005	1.236	.120	1.215	.446	.062	.087	1 1/16-18 UNEF
20	1.448	1.100	1.365	.120	1.275	.572	.094	.094	1EF
22	1.548	1.200	1.486	.120	1.275	.572	.094	.094	1EF
24	1.648	1.300	1.606	.120	1.275	.572	.094	.094	1EF

If you need any other information, please [E-Mail aecs@aecsinc.com](mailto:aecs@aecsinc.com)

phone (703) 425-3815 fax (703) 425-3814

We look forward to hearing from you!



A Woman Owned Small Business, CAGE Code 07BG6

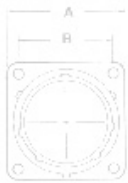

Allen Electric Connector Sales, inc.



TM

MS3476 PLUG, BAYONET COUPLING, CLASS A, L, S, W

SHELL SIZE	A MAX	B ±.005	C ±.035	D ±.035	E MAX	F -0.015	G ±.010	H MAX	JH-LEAD 2A
8	.828	.554	.568	.120	1.275	.446	.062	.087	1/2-20 UNF
10	.954	.719	.585	.120	1.275	.446	.062	.087	5/8-24 UNEF
12	1.047	.872	.564	.120	1.275	.446	.062	.087	3/4-20 UNEF
14	1.141	.906	.969	.20	1.275	.446	.062	.087	7/8-20 UNEF
16	1.234	.968	1.115	.20	1.275	.446	.062	.087	1-20 UNEF
18	1.328	1.062	1.236	.20	1.275	.446	.062	.087	1 1/16-18 UNF
20	1.418	1.150	1.365	.20	1.275	.446	.062	.087	1 3/16-18 UNEF
22	1.528	1.250	1.486	.20	1.275	.446	.062	.087	1 5/16-18 UNEF
24	1.703	1.375	1.615	.27	1.275	.446	.062	.087	1 7/16-18 UNF

SHELL SIZE	A MAX	B ±.005	C ±.035
8	.828	.554	.568
10	.954	.719	.585
12	1.047	.872	.564
14	1.141	.906	.969
16	1.234	.968	1.115
18	1.328	1.062	1.236
20	1.418	1.150	1.365
22	1.528	1.250	1.486
24	1.703	1.375	1.615



SHELL SIZE	A MAX	B ±.005	C ±.035	D ±.035	E MAX	F -0.015	G ±.010	H MAX	JH-LEAD 2A
8	.828	.554	.568	.120	1.275	.446	.062	.087	1/2-20 UNF
10	.954	.719	.585	.120	1.275	.446	.062	.087	5/8-24 UNEF
12	1.047	.872	.564	.120	1.275	.446	.062	.087	3/4-20 UNEF
14	1.141	.906	.969	.20	1.275	.446	.062	.087	7/8-20 UNEF
16	1.234	.968	1.115	.20	1.275	.446	.062	.087	1-20 UNEF
18	1.328	1.062	1.236	.20	1.275	.446	.062	.087	1 1/16-18 UNF
20	1.418	1.150	1.365	.20	1.275	.446	.062	.087	1 3/16-18 UNEF
22	1.528	1.250	1.486	.20	1.275	.446	.062	.087	1 5/16-18 UNEF
24	1.703	1.375	1.615	.27	1.275	.446	.062	.087	1 7/16-18 UNF

SHELL SIZE	A MAX	B THREAD-2A
8	.782	1/2-20 UNF
10	.926	5/8-24 UNEF
12	1.043	3/4-20 UNEF
14	1.183	7/8-20 UNEF
16	1.305	1-20 UNEF
18	1.391	1 1/16-18 UNF
20	1.531	1 3/16-18 UNEF
22	1.656	1 5/16-18 UNEF
24	1.777	1 7/16-18 UNF

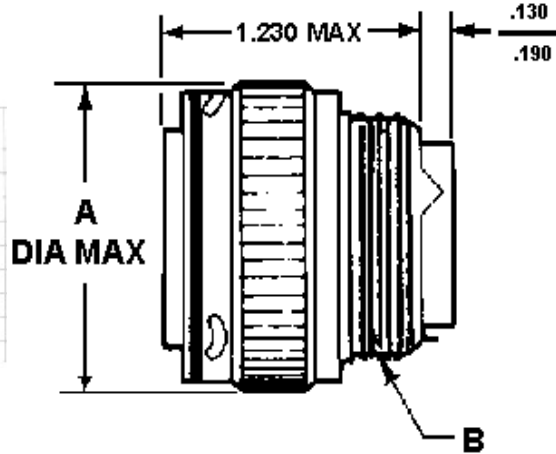

SHELL SIZE	A MAX	B ±.005
8	.828	.554
10	.954	.719
12	1.047	.872
14	1.141	.906
16	1.234	.968
18	1.328	1.062
20	1.418	1.150
22	1.528	1.250
24	1.703	1.375

SHELL SIZE	A MAX	B ±.005	C ±.035
8	.828	.554	.568
10	.954	.719	.585
12	1.047	.872	.564
14	1.141	.906	.969
16	1.234	.968	1.115
18	1.328	1.062	1.236
20	1.418	1.150	1.365
22	1.528	1.250	1.486
24	1.703	1.375	1.615

SHELL SIZE	A MAX	B ±.005	C ±.035	D ±.035	E MAX	F -0.0	G ±0.10	H MAX	J
8	828	554	568	120	1.275	446	062	087	29-24 UNEF
10	954	719	585	120	1.275	446	062	087	3/4-20 UNEF
12	1047	812	564	120	1.275	446	062	087	7/8-20 UNEF
14	1141	906	969	20	1.275	446	062	087	1 1/16-18 UNLF
16	1234	986	1115	20	1.275	446	062	087	1 1/8-18 UNLF
18	1328	1062	1236	20	1.275	446	062	087	1 3/16-18 UNLF
20	1418	1150	1365	20	1.275	446	062	087	1 1/2-18 UNLF
22	1528	1250	1485	20	1.275	446	062	087	1 5/8-18 UNLF
24	1703	1375	1615	47	1.275	446	062	087	1 7/8-18 UNLF

MILITARY PART NUMBERING SYSTEM

MS3476

L 22 - 21 S W

Polarization (Blank for normal, Alternate positions W, X, Y or Z)
Contact Style: P= Pins, S= Sockets, A= less Pins, B= less Sockets
Insert Arrangement: Per MIL-STD-1669
Shell Size: Even numbers 8 thru 24

Class:

- L** = Aluminum shell, electroless nickel finish
- A** = Aluminum shell, anodized finish, black (not applicable to MS3475)
- S** = Stainless steel, passivated
- W** = Aluminum shell, olive drab cadmium plated

MS Number: MS3470 Narrow flange receptacle
 MS3471 Cable connecting receptacle
 MS3472 Wide flange receptacle
 MS3474 Jam nut mount receptacle
 MS3475 RFI grounding Plug
 MS3476 Standard Plug

SHELL SIZE	A MAX	B ±.005	C ±.035	D ±.035	E MAX	F -0.0	G ±0.10	H MAX	J
8	828	554	568	120	1.275	446	062	087	29-24 UNEF
10	954	719	585	120	1.275	446	062	087	3/4-20 UNEF
12	1047	812	564	120	1.275	446	062	087	7/8-20 UNEF
14	1141	906	969	20	1.275	446	062	087	1 1/16-18 UNLF
16	1234	986	1115	20	1.275	446	062	087	1 1/8-18 UNLF
18	1328	1062	1236	20	1.275	446	062	087	1 3/16-18 UNLF
20	1418	1150	1365	20	1.275	446	062	087	1 1/2-18 UNLF
22	1528	1250	1485	20	1.275	446	062	087	1 5/8-18 UNLF
24	1703	1375	1615	47	1.275	446	062	087	1 7/8-18 UNLF

SHELL SIZE	A MAX	B ±.005	C ±.035
8	828	554	568
10	954	719	585
12	1047	812	564
14	1141	906	969
16	1234	986	1115
18	1328	1062	1236
20	1418	1150	1365
22	1528	1250	1485
24	1703	1375	1615

For pricing and availability, please fill out our RFQ form



If you need any other information, please [E-Mail aecs@aecsinc.com](mailto:aecs@aecsinc.com)



phone (703) 425-3815 fax (703) 425-3814

We look forward to hearing from you!



A Woman Owned Small Business, CAGE Code 07BG6

PANEL

PANEL CUTOUT

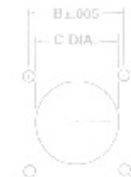

PANEL CUTOUT

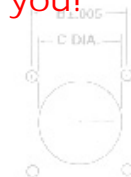

PANEL CUTOUT

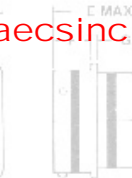

PANEL CUTOUT

SHELL SIZE	A MAX	B ±.005	C ±.035
8	828	554	568
10	954	719	585
12	1047	812	564
14	1141	906	969
16	1234	986	1115
18	1328	1062	1236
20	1418	1150	1365
22	1528	1250	1485
24	1703	1375	1615